

**Kern Delta Water District – KDWD 22-02 – Old River Basins Grading Project**  
**RFI Responses – November 10, 2022**

**REQUEST FOR INFORMATION #7.0 (Paraphrased):**

Sheet 26 of the plan set (showing the triple 48” HDPE road crossing) calls out for DR32.5 48” HDPE. Specifications section G calls for “Corrugated HDPE, Low Head, Water-Tight, Irrigation Pipe, as manufactured by ADS.” Which is correct?

**RESPONSE:**

All HDPE Piping purchased for this project shall be Corrugated HDPE, Low Head, Water-Tight, Irrigation Pipe, as manufactured by ADS. A revision to sheet 26 of the plan set has been issued to clarify this, and is attached to this RFI response.

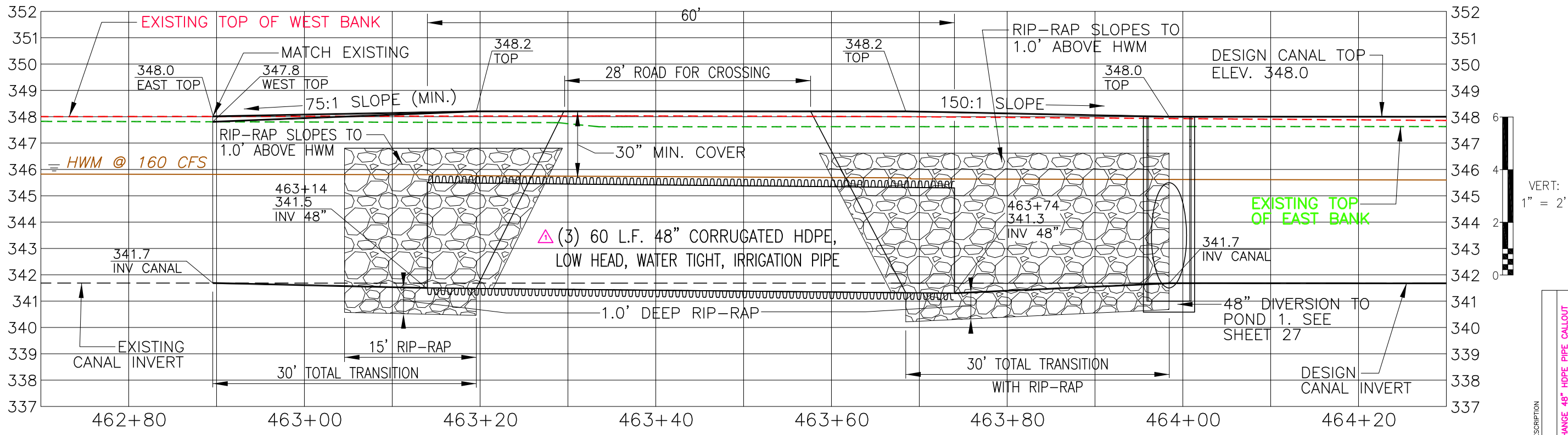
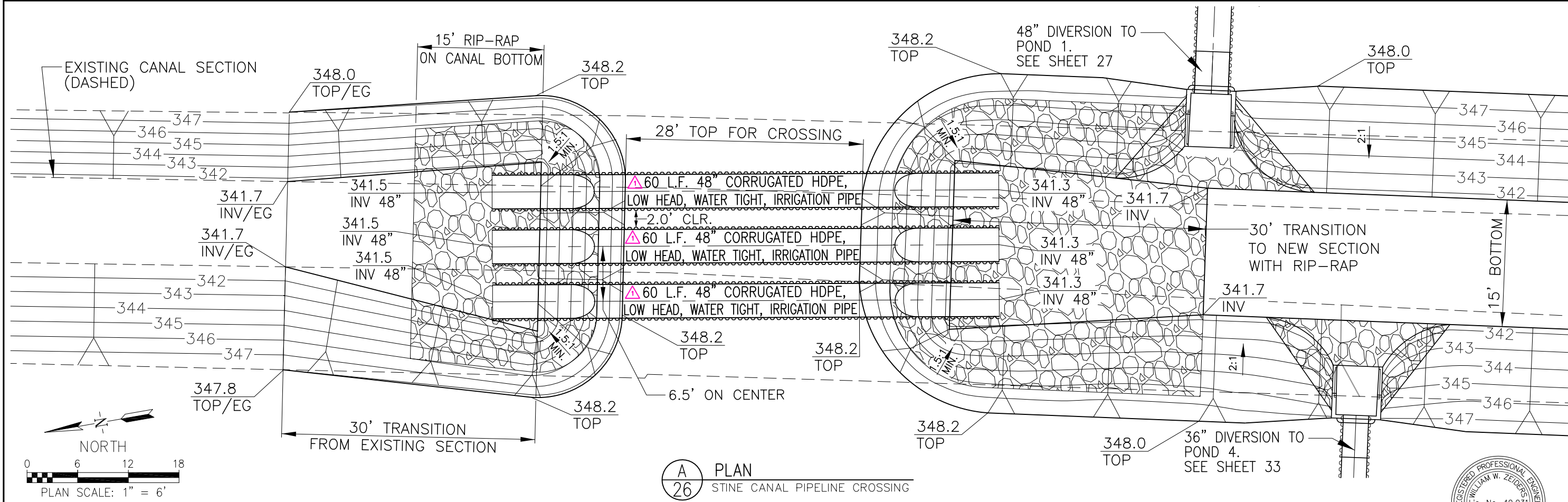

DRAWING NO. **26** of 37

**ZEIDERS CONSULTING**  
1655 GREBLEY ROAD  
BAKERSFIELD, CA. 93314  
(661) 589-8366

**KERN DELTA WATER DISTRICT**  
501 TAFT HIGHWAY, BAKERSFIELD, CALIFORNIA, 93307

**KERN DELTA WATER DISTRICT  
OLD RIVER GROUNDWATER RECHARGE FACILITY  
STINE CANAL 48" HDPE ROAD CROSSING**

REV.	DATE	DESCRIPTION
1	11/09/22	CHANGE 48" HDPE PIPE CALLOUT

DATE: OCTOBER 10, 2022  
SCALE: AS NOTED  
DRAWN BY: A. TAYLOR  
CHECKED BY: W. ZEIDERS  
FILE NAME: OLD RIVER - BASE